

APPLICATIONS

- Self-service merchandiser for “ready to eat” products, drinks.
- Impulse sales/Add ons
- Forced air refrigeration
- Medium temperature (34°-38°)

STANDARD FEATURES

CABINET CONSTRUCTION

- Base Cabinet and Counter Top consist of 3/4” plywood panels finished in high pressure plastic laminate
- Powder coated canopy and assembly
- Lighted Canopy with compact LED fixtures
- Solid Base
- Protective 1” vinyl bumper

SHELVING

- Two-tier style for displaying “ready to eat” products
- 1-1/4” Price tag molding on shelves

REFRIGERATION SYSTEM

- Self contained refrigeration with a standard refrigeration control.
- Condensate removal through a floor drain

ELECTRICAL REQUIREMENTS

- Pre-wired to 120V/208A plug, 60Hz, 1 phase circuit. (see reverse for details)

WARRANTY

- One year - Parts and Labor

OPTIONS / ACCESSORIES

- Assorted colors available for laminate, vinyl bumper and powder coat
- Powder coated canopy assembly
- Third tier of shelving available.
- Stainless or mirrored laminate accent strip between bumper and counter top
- Remote refrigeration
- Optional condensate removal devices available to eliminate need for plumbing.
- Circuit Breaker Panel instead of junction box.



Shown with optional finishes

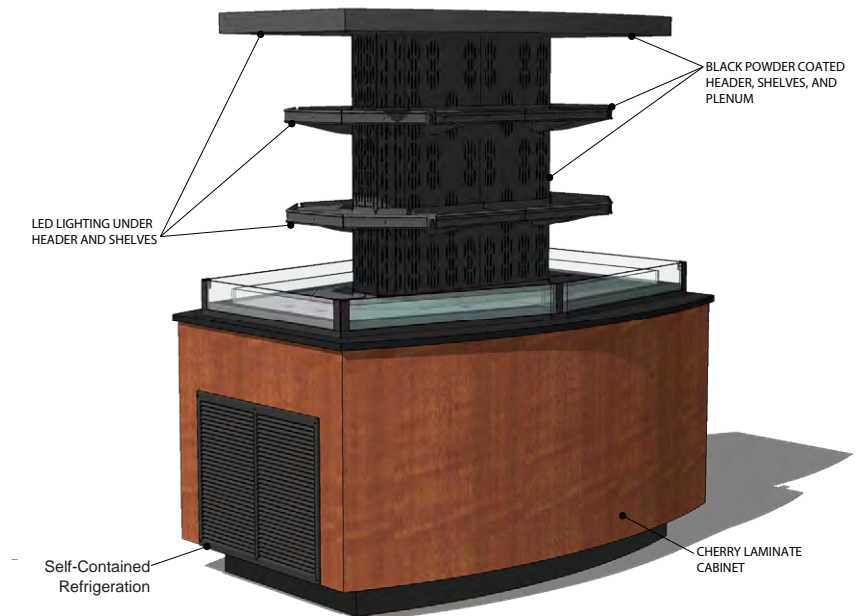

Engineered for stores with ambient conditions not to exceed 75°F and 55% relative humidity. Due to continuous improvements specifications may change without notice.

Built to meet the following specifications:



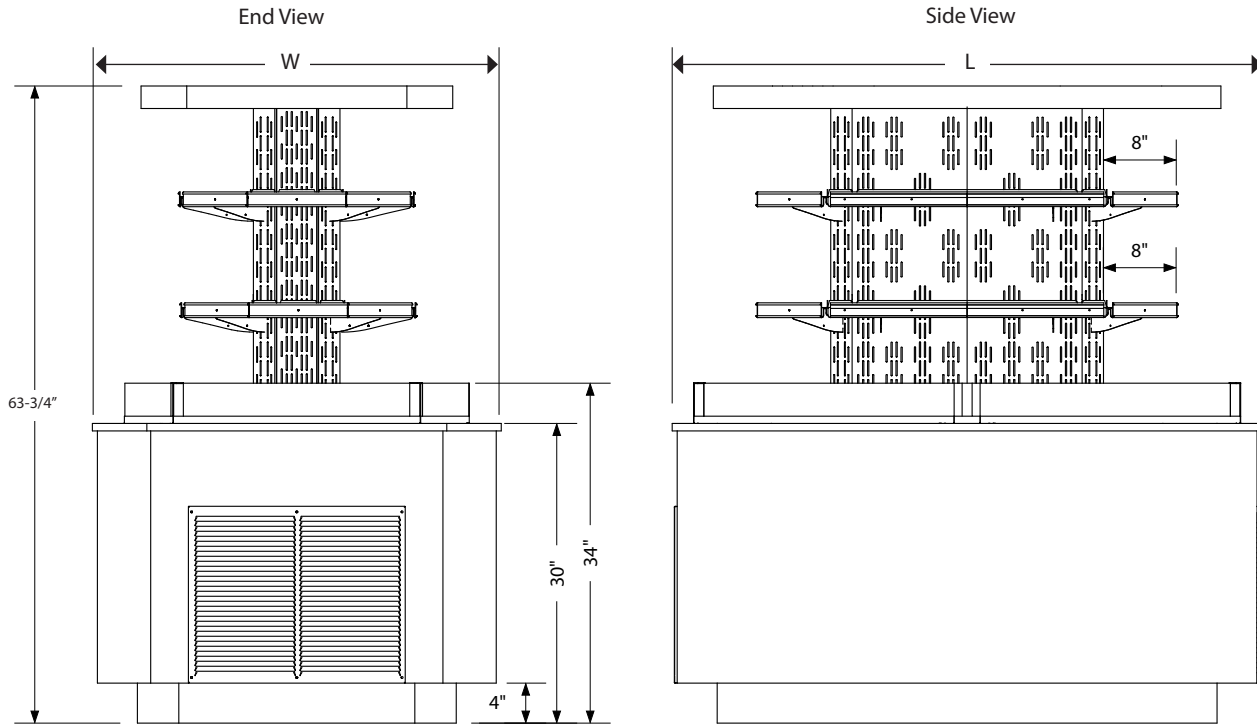

Refrigerated Island Merchandiser	Dimensions (inches)		
	W	L	H
40" x 60"	40"	60"	63 ³ / ₄ "
40" x 72"	40"	72"	63 ³ / ₄ "
56" x 84"	56"	84"	63 ³ / ₄ "

ELECTRICAL/REFRIGERATION SPECIFICATIONS - BASED ON 40" X 60" UNIT

ELECTRICAL REQUIREMENTS - ON 6' CORD NEMA 14-20F PLUG

QTY	DESCRIPTION	MANUFACTURER	MODEL #	VOLTAGE	AMPS EA	AMPS TOTAL
12	12" LED LIGHTS	ELECTRALED	EFDS-1-35-06-NM	120	0.05	0.6
4	36" LED LIGHTS	ELECTRALED	EFDS-3-35-06-NM	120	0.14	0.56
1	CONDENSING UNIT	TECUMSEH	AWA9511	208	12	12
4	FANS	EBM PAPST		120	1	4
TOTAL ELECTRICAL REQUIRED IS 120/208 V, 60 Hz, 1 PH						17.16

REFRIGERATION SPECS

QTY	DESCRIPTION	MANUFACTURER	MODEL #	BTU'S EA.	EVAP TEMP	REF. TYPE/OZ.
1	S.C. AIR OVER DISPLAY	R&D FIXTURES	N/A	10000	+20°	404-A