

Refrigerated Grab-N-Go Merchandiser

R-GNG-LPRO-3, R-GNG-LPRO-4, R-GNG-LPRO-6

APPLICATIONS

- Self-service merchandiser for packaged deli items/sandwiches.
- Impulse sales
- Add ons
- Forced air refrigeration
- Medium temperature (36°- 40°)

STANDARD FEATURES

CABINET CONSTRUCTION

- Galvanized steel frame construction
- Finished in high pressure plastic laminate
- Stainless steel interior
- Solid side panels

SHELVING

- Three shelves with ticket molding standard on all models.
- Adjustable to 3 angled positions
- Removable stainless steel deck pans
- LED lights illuminate shelf area below

REFRIGERATION SYSTEM

- Self-contained refrigeration
- Drains to condensate pan
- Energy saving EC motor
- Automatic self defrost
- Solar thermometer and refrigeration control on front of unit

ELECTRICAL REQUIREMENTS

- Pre-wired to 120V/208A plug, 60Hz, 1 phase circuit. (see reverse for details)

WARRANTY

- One year - Parts and Labor

OPTIONS / ACCESSORIES

- Many other laminate finishes available
- Assorted colors for vinyl bumper
- Black Powder Coated interior
- Mirrored or stainless steel interior end panels
- Glass end panels
- Pull down night curtain keeps cold air inside to save energy
- Optional condensate removal devices available to eliminate need for plumbing.
- Remote refrigeration
- Casters with skirting. Adds 4" to overall height.

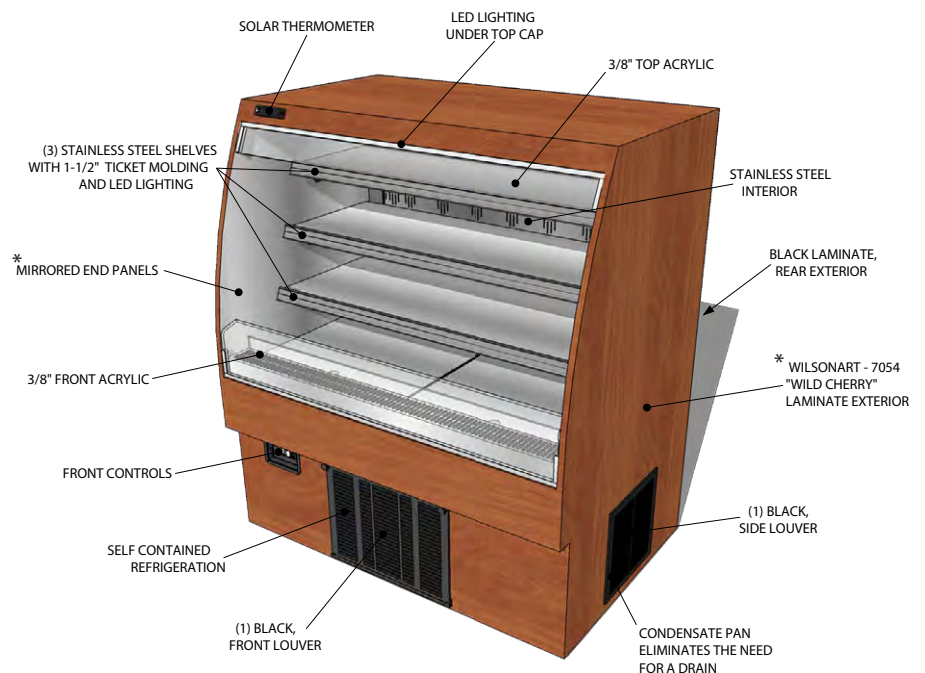

*Units shown have been customized with typical options.
 Standard Unit pricing includes black laminate exterior with solid side panels.

Engineered for stores with ambient conditions not to exceed 75°F and 55% relative humidity. Due to continuous improvements specifications may change without notice.

Built to meet the following specifications:



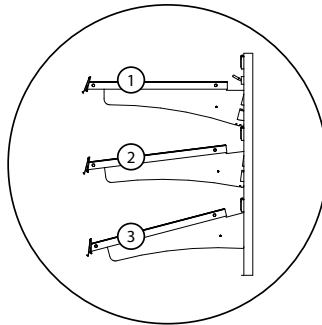
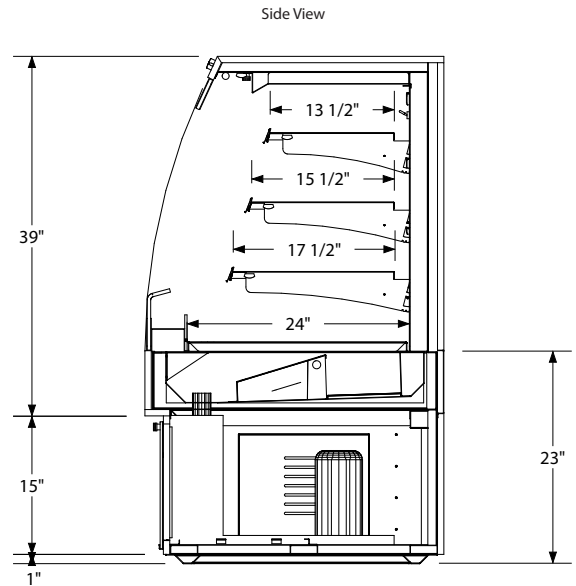
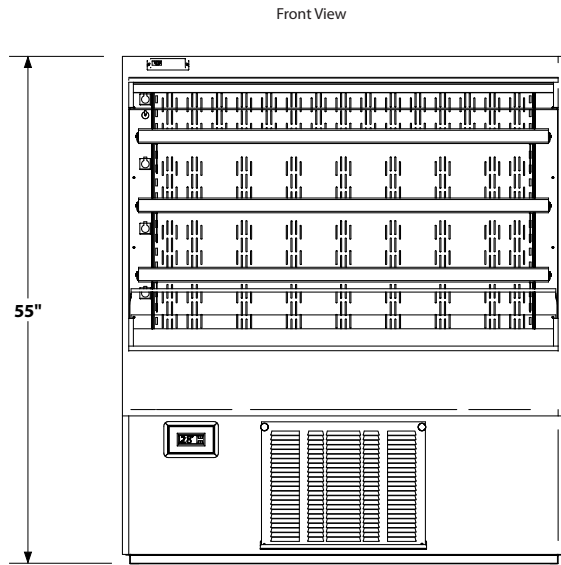

Shelves can be adjusted to 3 different angled positions

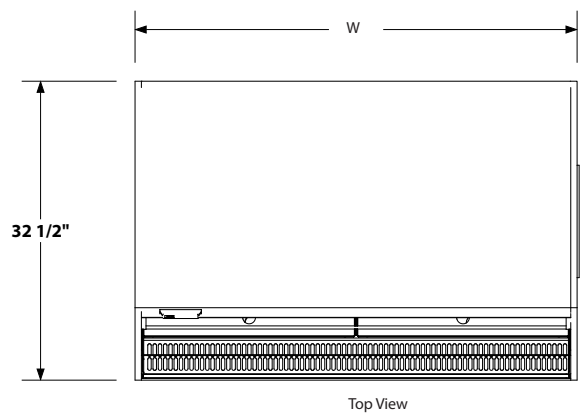

Unit Width	Dimensions (inches)		
	W	D	H
3'	36	32 1/2	55
4'	48	32 1/2	55
6'	72	32 1/2	55

ELECTRICAL/REFRIGERATION SPECIFICATIONS - (BASED ON A 48" UNIT)

ELECTRICAL REQUIREMENTS - ON 6' CORD NEMA 14-20F PLUG

QTY	DESCRIPTION	MANUFACTURER	MODEL #	VOLTAGE	AMPS EA	AMPS TOTAL
1	CONDENSING UNIT	TECUMSEH	AKA9460ZXAXC	120	10.8	10.8
1	DIGITAL TEMP CONTROL	DIXELL	XR20C	120	0.025	0.025
1	FAN	EBM PAPST	W1G2C0-EC95-Y7	120	0.48	0.48
4	34" LED LIGHT, 3500K	ELECTRALED	EFDS-3-3500	120	0.04	.016
TOTAL ELECTRICAL REQUIRED IS 120/208 V, 60 Hz, 1 PH						11.321

REFRIGERATION SPECS

QTY	DESCRIPTION	MANUFACTURER	MODEL #	BTU'S EA.	EVAP TEMP	REF. TYPE/OZ.
1	AIR OVER DISPLAY	R&D FIXTURES	N/A	4500	+20°	404-A