

## APPLICATIONS

- Dual Zone Self Service Merchandiser
- Top: Dry Grab-n-Go
- Bottom: Refrigerated Grab-n-Go

## STANDARD FEATURES

### CABINET CONSTRUCTION

- All metal frame construction
- Lift up front curved, tempered glass protects upper dry section
- Sliding glass doors allow access to rear of top section
- Stainless steel canopy with glass end panels
- Removeable side panels allow for multiple units to be connected together for a continuous display
- Rear lift-up work shelf
- Finished in high pressure plastic laminate
- Stainless steel interior
- 2" Thick insulated panel provides thermal break between refrigerated and dry sections

### REFRIGERATION SYSTEM

- Self-contained air-over display
- Condensate drains to floor drain
- Automatic self defrost
- Solar thermometer and refrigeration control on front of unit
- Refrigeration controls on back of unit

### SHELVING

#### Dry Top Section:

- Glass shelf overhead LED Lighting
- Stainless steel deck

#### Refrigerated Lower Section:

- 1 Stainless Steel adjustable shelf with overhead LED Lighting
- Lower Self-service base with removable stainless steel deck pans

### ELECTRICAL REQUIREMENTS

- Pre-wired to junction box

### WARRANTY

- One year - Parts and Labor

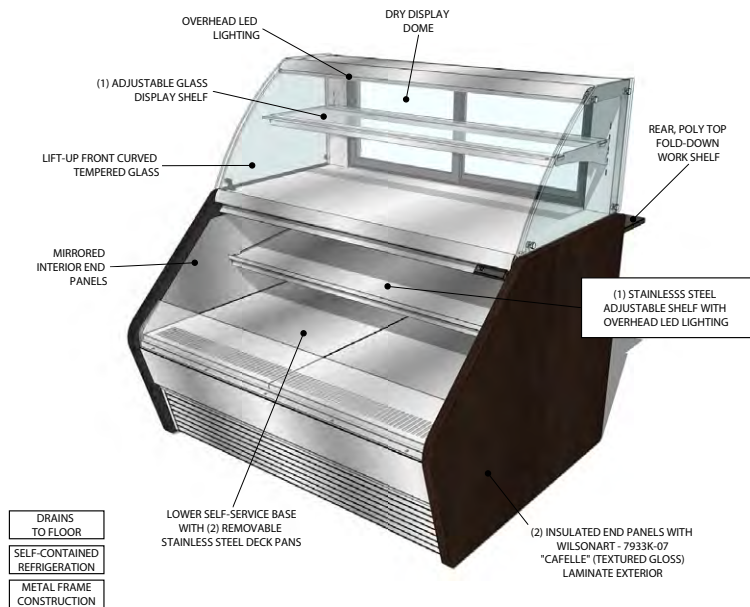

Engineered for stores with ambient conditions not to exceed 75°F and 55% relative humidity. Due to continuous improvements specifications may change without notice.

## OPTIONS / ACCESSORIES

- Many laminate finishes available
- Assorted colors for vinyl bumper
- Mirrored or stainless steel interior end panels
- Powder Coated Canopy, assembly, and corner guards
- Optional condensate removal devices available to eliminate need for plumbing.
- Remote refrigeration

Built to meet the following specifications:



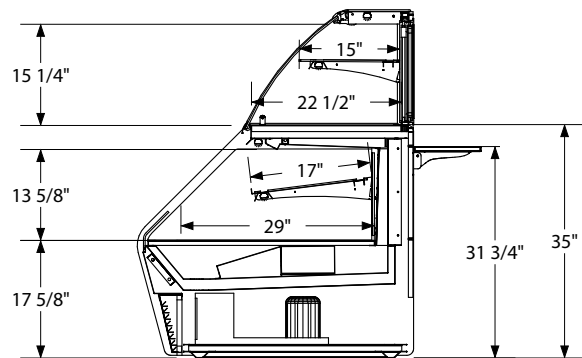
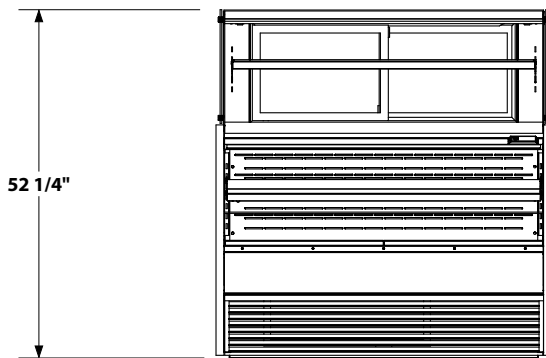
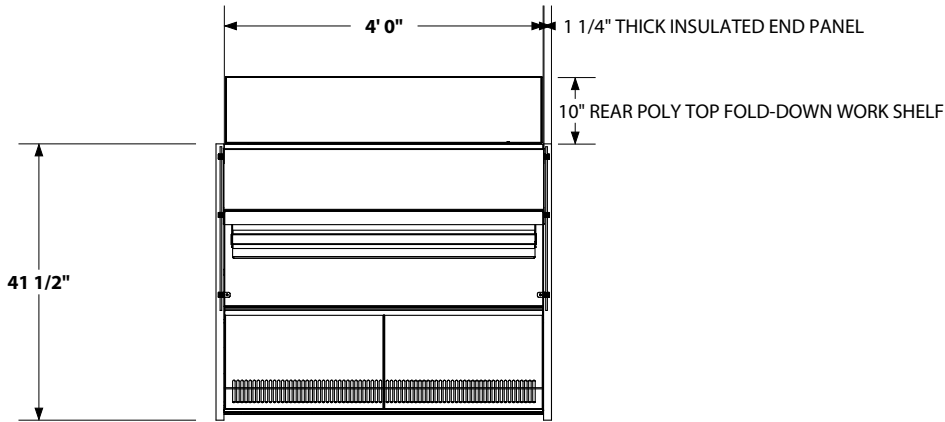

## ELECTRICAL/REFRIGERATION SPECIFICATIONS (WIRED TO LOAD CENTER)

ELECTRICAL SPECIFICATIONS			
QTY	DESCRIPTION	VOLTAGE	AMPS TOTAL
1	CONDENSING UNIT	120	7.7
1	DIGITAL TEMP CONTROL	120	.25
1	FAN	120	.27
2	24" LED LIGHTS, 3500K	120	.4
TOTAL ELECTRICAL REQUIRED IS 120 V, 60 Hz, 1 PH			8.62

REFRIGERATION SPECIFICATIONS				
QTY	TYPE	BTU'S EA.	EVAP TEMP	REF. TYPE/OZ.
1	AIR OVER DISPLAY	4000	+20°	R134-A