

APPLICATIONS

- Natural looking display is ideal for merchandising bread and bakery items

STANDARD FEATURES

CABINET CONSTRUCTION

- Cabinet consists of 3/4" plywood panels finished in high pressure plastic laminate.
- Box or 1/4 depth end panels
- 1 row of protective 1" vinyl bumpers.
- 3" high toe-kick base.

SHELVING

- (4) 2" oak wood slat shelves with ticket molding
- Brackets allow shelf to be adjusted to 3 different angles
- Full height shelf support pilasters with slotted holes on 1" centers for vertical shelf adjustments.
- LED lighting under front edge of canopy and below shelves to illuminate product
- All hardware is powder coated.

OPTIONS / ACCESSORIES

- Many laminate finishes available
- Canopy with radius front edge
- Box (full depth) end panels
- Alternate sizes and configurations
- Mirrored interior back wall.
- Extra shelves
- Unit can be pre-wired and furnished with a junction box for use on a dedicated 120V/15A, 60Hz, 1 phase circuit.



Shown with mirrored back wall & without canopy

Image, left: Shown with custom right end panel
 Left end panel shown with "Box" option
 Optional laminate and shelving stain color.



Optional

Radius Edge Canopy

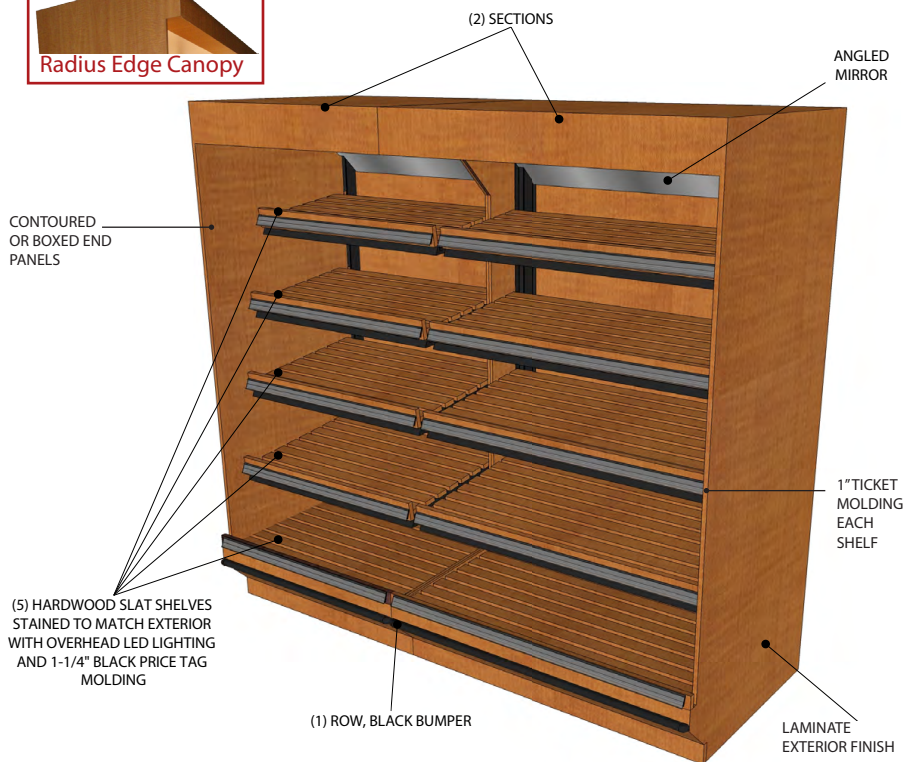

Engineered for stores with ambient conditions not to exceed 75°F and 55% relative humidity. Due to continuous improvements specifications may change without notice.

Built to meet the following specifications:



LINE DRAWINGS BASED ON A 12' DISPLAY MADE UP OF (3) 4' UNITS

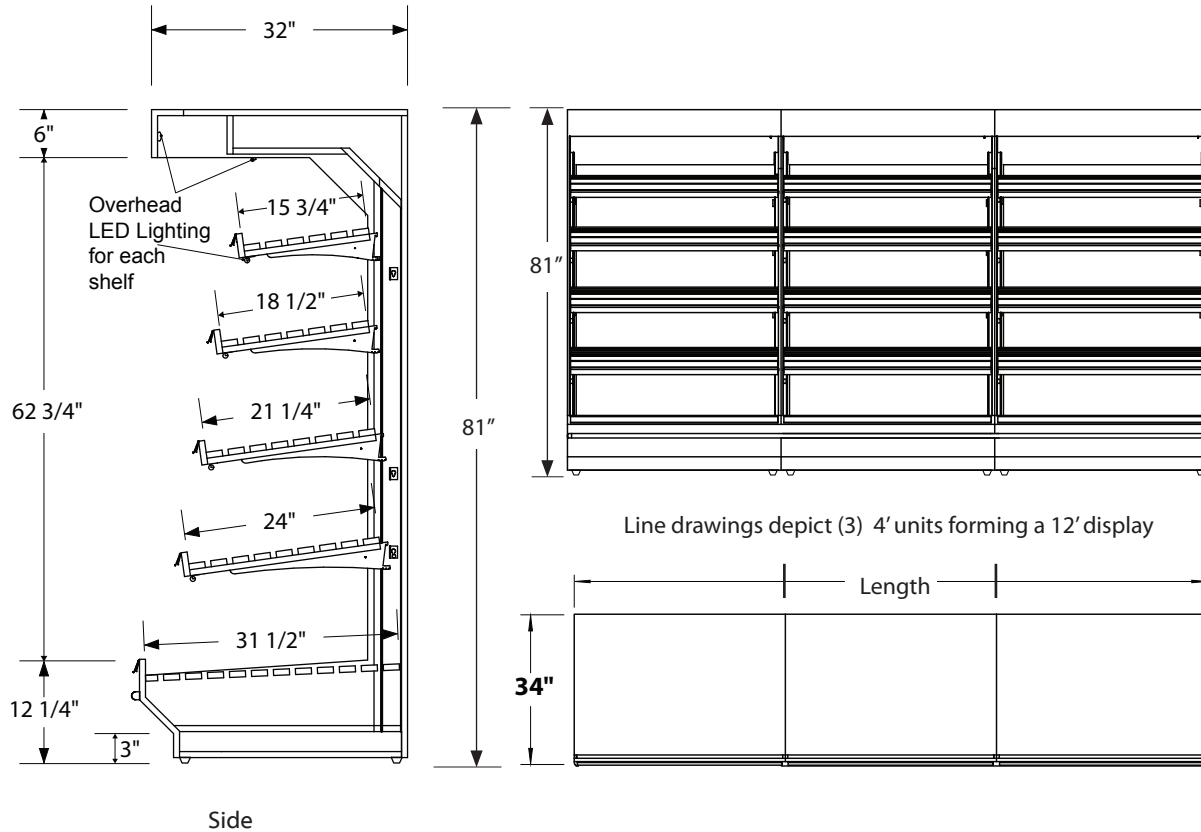

Side

Length/ Product #	Dimensions (inches)		
	W	D	H
3' - AR-BR-3	36	35	81
4' - AR-BR-4	48	35	81
6' - AR-BR-6	72	35	81

ELECTRICAL REQUIREMENTS PER 4' CASE WITH OPTIONAL UNDERSHELF AND CANOPY LIGHTS

QTY.	DESCRIPTION	MANUFACTURER	MODEL #	VOLTAGE	AMPS EA	AMPS TOTAL
4	34" LED LIGHTS	ELECTRALED	EFDS-3-3500	120	0.13	0.52
1	46" LED LIGHT	ELECTRALED	EFDS-4-3500	120	0.18	0.18
TOTAL ELECTRICAL REQUIRED IS 120V, 60 Hz, 1 Ph WIRED TO JUNCTION BOX						0.7