

Classic / Upright Pastry Case

CL-BR-2DR, CL-BR-3DR, CL-BR-4DR

APPLICATIONS

- Enclosed self-service display is ideal for bakery/pastry, doughnuts/bagels, rolls.

STANDARD FEATURES

CABINET CONSTRUCTION

- Front, end panels, and all edges to consist of 3/4" plywood panels finished in high pressure laminate.
- Deck to be laminated plywood
- Powder coated interior
- 1/4" thick tempered glass doors with automatic door closers with stay open feature
- Front storage recess for packaging supplies and trash receptacle(s)
- 2 rows of protective 1" vinyl bumpers.
- 5-3/4" high toe-kick base.
- Fixture is designed to NEC, UL and NSF standards.

SHELVING

- Adjustable steel wire shelves are easily removeable
- Full height shelf support pilasters with slotted holes on 1" centers for vertical shelf adjustments.
- Brackets allow shelf to be adjusted to 3 different angles to increase visibility.
- LED lights illuminate shelf area below and come with on/off switch

ELECTRICAL REQUIREMENTS

- Unit is pre-wired and furnished with a junction box for use on a dedicated 120V, 60Hz, 1 phase circuit

WARRANTY

- One year - Parts

OPTIONS / ACCESSORIES

- Many colors available for laminate, vinyl bumper and powder coat
- Extra shelves
- Glass or sheet metal shelves
- Top with radius front edge
- Stainless steel interior
- Stainless steel tissue & trash chute covers
- Alternate sizes and configurations



Above: 2 - Five door cases side by side shown with optional radius top and counter recesses

Rendering shows a 4 door upright case with optional colors

Optional



Radius Edge Canopy



Engineered for stores with ambient conditions not to exceed 75°F and 55% relative humidity. Due to continuous improvements specifications may change without notice.

Built to meet the following specifications:



LINE DRAWINGS BASED ON A 4 DOOR MODEL

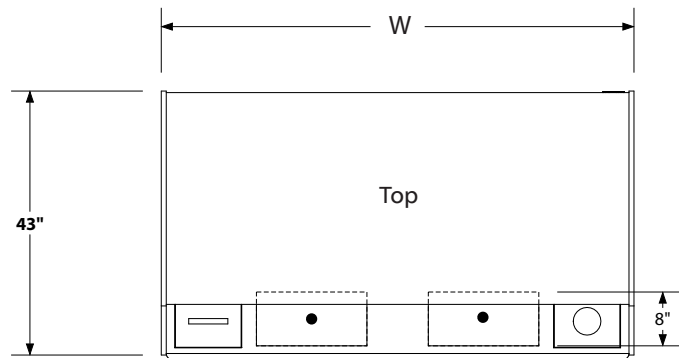
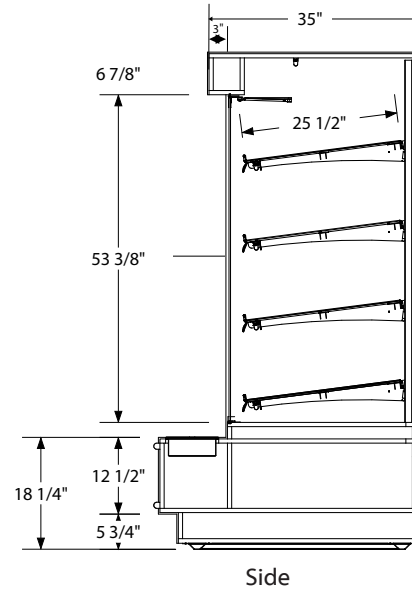
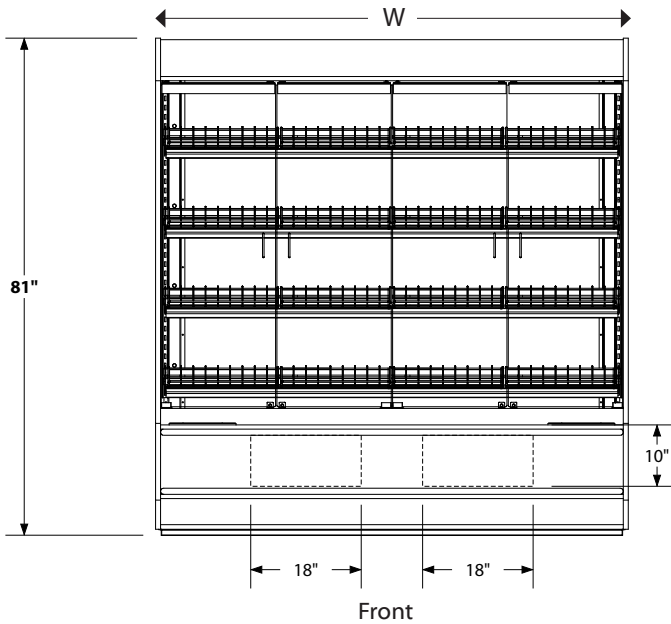

| Classic Upright Pastry Case | Dimensions (inches) | | |
|-----------------------------|---------------------|----|----|
| | W | D | H |
| 2 Door - CL-BR-2DR | 40 | 44 | 81 |
| 3 Door - CL-BR-3DR | 58 | 44 | 81 |
| 4 Door - CL-BR-4DR | 77 | 44 | 81 |
| 5 Door - CL-BR-5DR | 96 | 44 | 81 |

ELECTRICAL REQUIREMENTS PER 4 DOOR CASE WITH OPTIONAL UNDERSHELF AND CANOPY LIGHTS

| QTY. | DESCRIPTION | MANUFACTURER | MODEL # | VOLTAGE | AMPS EA | AMPS TOTAL |
|--|----------------|--------------|-----------------|---------|---------|------------|
| 10 | 34" LED LIGHTS | ELECTRALED | EFDS-3-35-06-NM | 120 | 0.14 | 1.4 |
| TOTAL ELECTRICAL REQUIRED IS 120V, 60 Hz, 1 Ph WIRED TO JUNCTION BOX | | | | | | 1.4 |