

APPLICATIONS

- Self-service doughnut/pastry case
- Case warmer with front controls
- Variable warmth up to 160°

STANDARD FEATURES

CABINET CONSTRUCTION

- Base Cabinet consists of 3/4" plywood panels finished in high pressure plastic laminate (black, white, or almond)
- Header flips up to access heater controls for each shelf.
- Solid back panel
- (2) 1/4" Tempered glass doors
- 1 Tissue holder
- 1 recess for product bags
- 1 trash bin
- 2 rows protective 1" vinyl bumper (Black)

SHELVING

- 4 wire shelves with overhead heat
- LED lighting
- 1-1/4" Price tag molding on shelves

ELECTRICAL REQUIREMENTS

- Pre-wired to 120V/208A plug, 60Hz, 1 phase circuit. (see reverse for details)

WARRANTY

- One year - Parts and Labor

OPTIONS / ACCESSORIES

- Assorted colors available for laminate, and vinyl bumper.
- Circuit Breaker Panel in lieu of junction box.
- Tissue and trash lids are available with stainless steel or powder coat finish
- 20 9"x24" Pastry trays



Easy access to warmer controls under lift-up front panel.

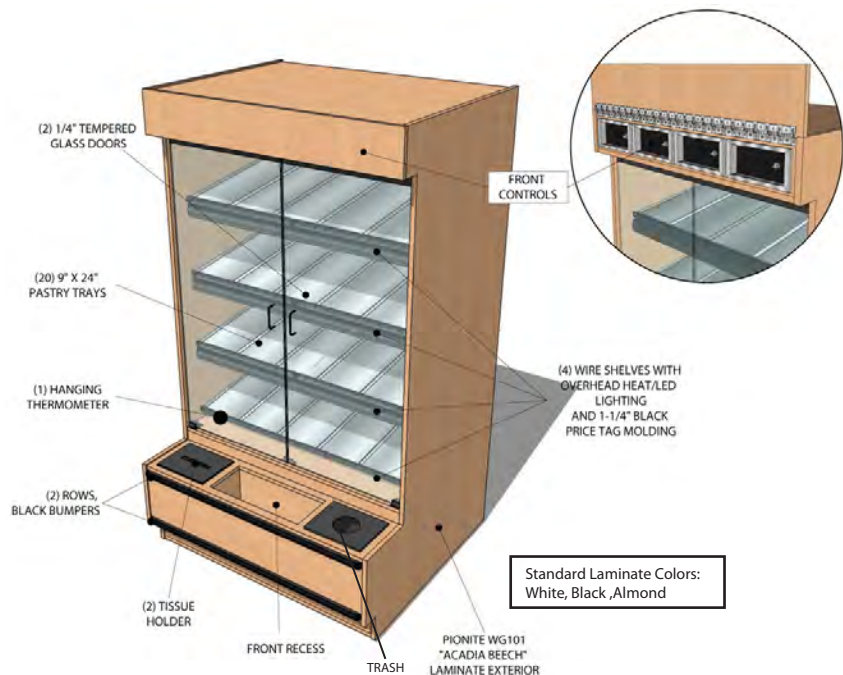

Engineered for stores with ambient conditions not to exceed 75°F and 55% relative humidity. Due to continuous improvements specifications may change without notice.

Built to meet the following specifications:



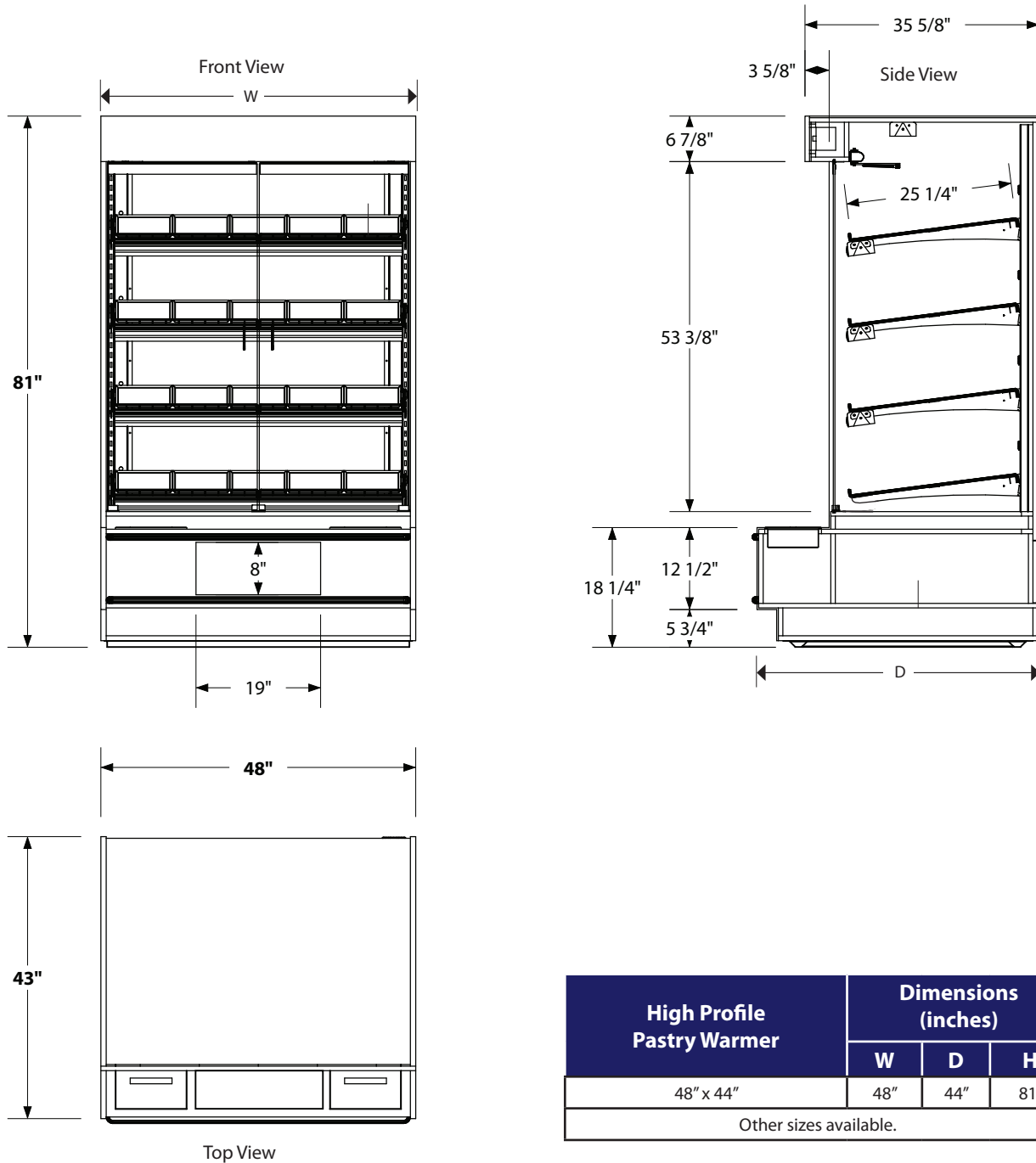

High Profile Pastry Warmer	Dimensions (inches)		
	W	D	H
48" x 44"	48"	44"	81"
Other sizes available.			

ELECTRICAL SPECIFICATIONS - BASED ON 43" X 48" UNIT

ELECTRICAL REQUIREMENTS - ON 6' CORD NEMA 14-20F PLUG

QTY	DESCRIPTION	MANUFACTURER	MODEL #	VOLTAGE	AMPS EA.	AMPS TOTAL
4	OVERHEAD HEAT LIGHTS	HATCO	GRN-4L-42	120	7.3	29.2
TOTAL ELECTRICAL REQUIRED IS 120/208 V, 60 Hz, 1 PH						29.2